

FINISHING



ULTRAFINISH

Colour	Packaging	Consumption
White	Paper Bag 15 Kg	1.2-1.5 (kg/m ²)/mm thickness

DESCRIPTION

White cement-based patina stucco, made of hydrated lime, high-quality marble sand, special synthetic resin, and specific additives. Reinforced with fibers. Features excellent workability, very good adhesion on both horizontal and vertical surfaces. Can be applied up to 3 mm thickness. After sanding with sandpaper, it gives a smooth finish.

FIELD OF APPLICATION

Used for stucco on walls and ceilings on concrete, drywall, and plaster surfaces, for both exterior and interior spaces. Patina stucco should be applied at temperatures from +5°C to +35°C.

SUBSTRATE PREPARATION

The base must be clean, free of dust, oils, paints, or residues that block bonding between layers. Cleaning is done mechanically or manually. If the surface has large uneven areas, it must be leveled. Before application, the surface is wetted with water.

APPLICATION

Mix 5.5-6 liters of water with one 15 kg bag of product using an electric mixer at low speed until a smooth, lump free mixture is achieved. Let the mixture rest for 5 minutes, then mix again before use. Apply the product with a stainless steel trowel and level it to a thickness of 3 mm. Weather conditions affect the drying time.



TECHNICAL DATA

Appearance: Powder	Thickness: 1-2 mm/hand
Packaging: 15 kg bags on pallets of 1080 kg.	Paint Application: 2 days
Colour: White	pH of mixture: 13
Consumption: 1.2-1.5 kg/m2 (3mm thickness)	Granulometry: 0.1 mm
Storage: On wooden pallets	Application Temperature: +5°C deri në +35°C
Application Method: 2 hands	Compressive strength: 4.2 N/mm²
Storage Time: 12 months from the production date	Water Absorption: WO
Bulk Density: 1.15gr/cm3	Thermal conductivity: 0.36 λ 10,dry
Water Mixture: 5.5-6 liters of water for 25 kg	Reaction to fire: Class A1

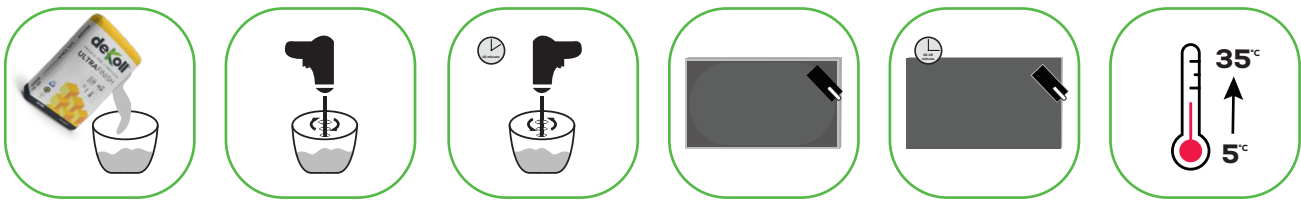

WARNING! Do not apply Finos on highly flexible bases like kapot systems or other flexible products, on unstable surfaces, or large uneven areas. Both low and high temperatures can change the product's working properties (slowing down or speeding up drying). Do not use on:

- Wood, metal, PVC, or other non-cement-based surfaces.
- Areas with continuous humidity.
- Surfaces with unstable vibrations.
- High or low temperatures, or strong winds.