

FINISHING



PINTOFINISH

Colour	Packaging	Consumption
White	Paper Bag 15 Kg	1.2-1.5 (kg/m ²)/mm thickness

DESCRIPTION

White cement-based patina stucco, made of hydrated lime, high-quality sand, special synthetic resins, and specific additives. It has excellent workability and spreads well on both horizontal and vertical surfaces. Can be applied up to 3 mm thick. After sanding with sandpaper, it gives a smooth finish.

FIELD OF APPLICATION

Used for stucco on walls and ceilings on drywall, fine plaster, and regular plaster surfaces, in interior areas that will later be covered with paint, wallpaper, or decorative coatings. Patina stucco should be applied at temperatures from +5°C to +35°C.

SUBSTRATE PREPARATION

The base must be clean, free of dust, oils, paints, or residues that block bonding between layers. Cleaning is done mechanically or manually. If the surface has large uneven areas, it must be leveled.

APPLICATION

Mix 5–5.5 liters of water with one 15 kg bag of product using a low-speed electric mixer until a smooth, lump-free mixture is achieved. Let the product rest for 5 minutes, then mix again before use. Apply the product with a stainless steel trowel and level it to a thickness of 3 mm. Weather conditions affect the drying time.

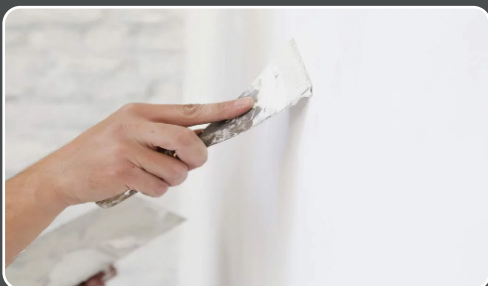

TECHNICAL DATA

Appearance: Powder	Storage Time: 12 months from the production date.
Packaging: 15 kg paper bags on 1080 kg pallets.	Bulk Density (dry): 1.5 gr/m³
Colour: White	Water for mixture: 5.5-6 liters of water for 15 KG
Granulation: < 0.1 mm	Application Temperature: +5°C to +35°C
Consumption: 1.2-1.5 kg/m²	Compressive strength: ≥ 1.6 N/mm²
Application Thickness: 3mm	pH of mixture: 13
Application Method: 2 hands	Water Absorption: WO
Waiting time for the second hand: 1 hour	Reaction to fire: Class A1
Storage: Store in dry places on wooden pallets.	

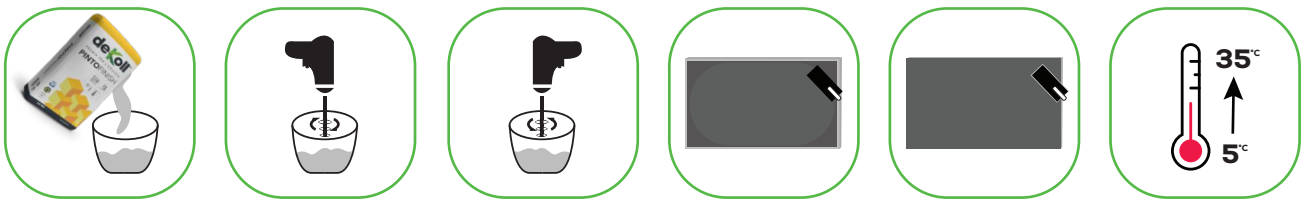

WARNING! Do not apply Finos on highly flexible bases like kapot systems or other flexible products, on unstable surfaces, or large uneven areas. Both low and high temperatures can change the product's working properties (slowing down or speeding up drying). Do not use on: Wood, metal, PVC, or other non-cement-based surfaces. Areas with continuous humidity. Surfaces with unstable vibrations. High or low temperatures, or strong winds.