

FINISHING



GRATEX

Colour	Packaging
White	Paper Bag 25 Kg

Granulation	Consumption
1V	2.7 kg/m ²
1.5V	3.0 kg/m ²
1.5R	3.0 kg/m ²
2R	3.1 kg/m ²
3R	3.5 kg/m ²

DESCRIPTION

Decorative coating based on white cement made of high quality marble sand, special additives, and water repellent agents, offering a beautiful and durable structure for interior and exterior walls. Easy to apply and provides long working time, creating a durable and attractive surface. The product is also waterproof, making it ideal for protecting and decorating facades.

FIELD OF APPLICATION

Applied over cement-lime filler plaster. All types of bases are pre-treated with a leveling compound.

SUBSTRATE PREPARATION

The base must be clean, free of dust, oils, or residues that block bonding between layers. Cleaning is done mechanically. Before applying the product, all base types must be leveled with a leveling compound and primed with Grafiato primer.

APPLICATION

Mix the product with an electric mixer in a clean container with water until a homogeneous mixture is achieved. Apply the product with a flat metal trowel. Then smooth it with a plastic trowel in vertical, horizontal, or circular motions, depending on the texture desired. Clean the tools after finishing work. Optimal working temperatures are from 5°C to 35°C.

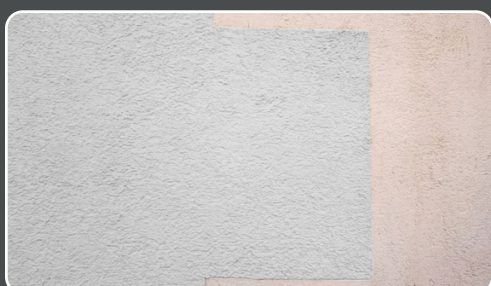
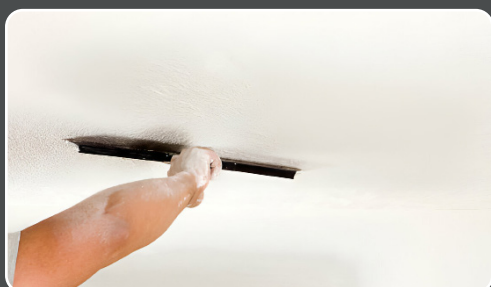
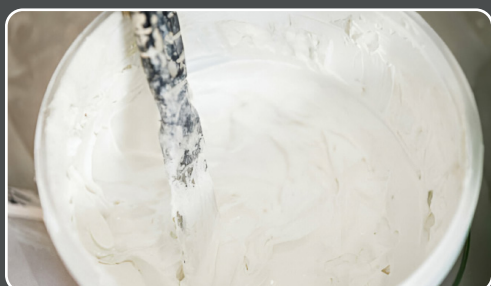

TECHNICAL DATA

Appearance: Powder	Compressive strength after 28 days: $\geq 5 \text{ N/mm}^2$
Packaging: Bags of 25 kg on pallets of 1350 kg.	Grafiato 1 mm, Full texture: 2.7 kg/m ²
Colour: White	Grafiato 1.5R mm, Striped structure.: 3 kg/m ²
Storage: Store in dry places on wooden pallets.	Grafiato 1.5 V mm, Full texture: 3 kg/m ²
Storage Time: 12 months from the production date.	Grafiato 2 mm, Striped structure.: 3.1 kg/m ²
Water for mixing.: 6 liters of water for 25 kg	Grafiato 3mm, Striped structure.: 3.5 kg/m ²
Maximum application thickness: As maximum grain size.	Absorption: W0
pH of mixture: 13	Reaction to fire: Class A1
Application Temperature: +5°C to +35°C	

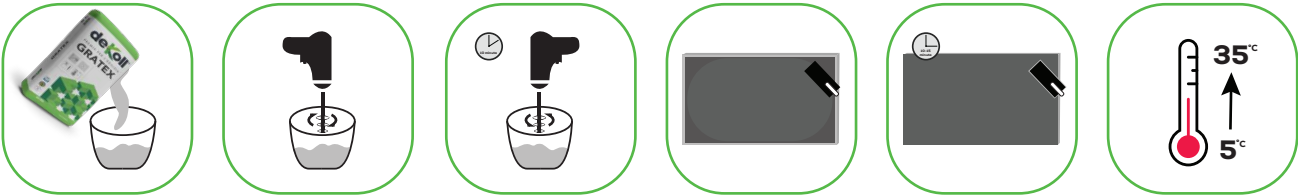

During application, ensure ambient temperature is above 5°C and below 35°C, and avoid contact with the face as the product is classified as an irritant. Direct exposure to sun, rain, wind, and humidity affects product quality.