

FINISHING



GRAFIATOT

Colour	Packaging
White	Bag 25 Kg

Granulometry	Consumption
1V	2.7 kg/m ²
1.5V, 1.5R	3 kg/m ²
2V, 2R	3 kg/m ²
3R	3.5 kg/m ²

DESCRIPTION

Decorative coating for indoor and outdoor environments based on white cement. Powder material composed of high-quality marble sand, special additives, hydrophobic agents, and hydrated lime. Characterized by very good workability, long working time, quick application creating a beautiful and uniform texture. It is recommended that the grafiato layer be painted. Offers high resistance to weather conditions, allows good vapor diffusion, and has moisture resistant properties.

FIELD OF APPLICATION

Applied over cement lime filling plasters. All types of substrates are first treated with a leveling compound. Suitable as a final coating and for thermal insulation systems.

SUBSTRATE PREPARATION

The substrate must be clean, free of dust, oils, or residues that hinder bonding between layers. The substrate cleaning is done mechanically. Before applying the product, it is necessary to level all types of substrates with a leveling compound. If the substrate has a high temperature, it is recommended to apply a primer on the surface.

APPLICATION

Mix the product with water in a clean container using an electric mixer until a homogeneous mixture is achieved. Apply the product with a straight metal trowel. Then level it with a plastic trowel in a vertical, horizontal, or circular motion, depending on the type of texture you want to create. Clean the tools after finishing the work. The optimal working temperatures are from 5°C to 35°C.



TECHNICAL DATA

Appearance: Powder	Flexural strength: $\geq 2.5 \text{ N/mm}^2$
Packaging: A pallet contains 1350 kg of 25 kg bags.	Thermal conductivity: 0.52 W/mK
Colour: White	Grafiato 1V, full texture: 2.7 kg/m ²
Storage: Store in dry places on wooden pallets.	Grafiato 1.5R, Grooved texture: 3 kg/m ²
Storage Time: 12 months from the production date	Grafiato 1.5V, Full texture: 3 kg/m ²
Application Thickness: Maximum size of the largest granule.	Grafiato 2R, Grooved texture: 3.1 kg/m ²
Water mixture: 6 liters of water for 25 kg	Grafiato 3R, Grooved texture: 3.5 kg/m ²
pH of mixture: 13	Water Absorption: W1
Application Temperature: +5°C to +35°C	Reaction to fire: Class A1
Compressive strength after 28 days: $\geq 7.5 \text{ N/mm}^2$	

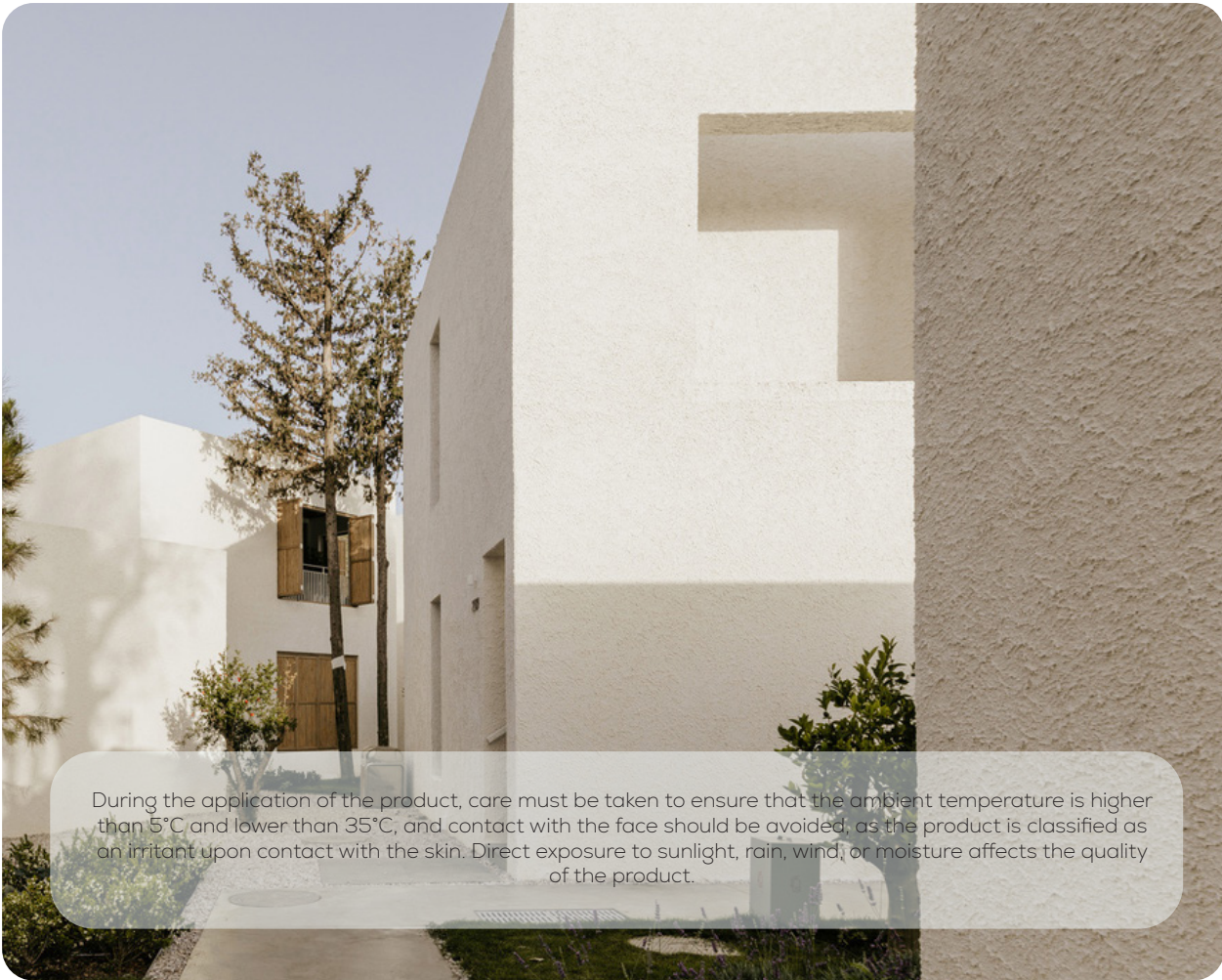
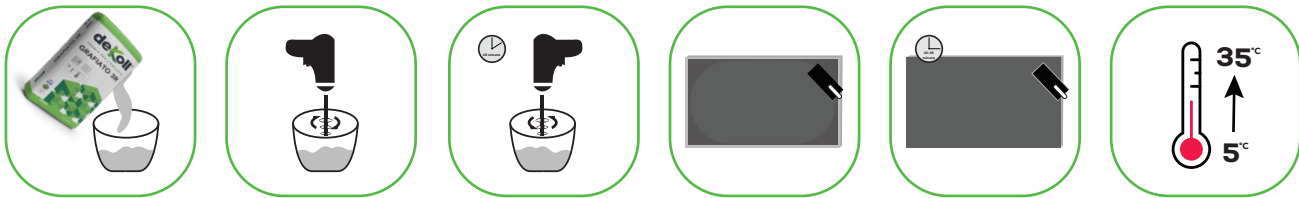

During the application of the product, care must be taken to ensure that the ambient temperature is higher than 5°C and lower than 35°C, and contact with the face should be avoided, as the product is classified as an irritant upon contact with the skin. Direct exposure to sunlight, rain, wind, or moisture affects the quality of the product.