

FINISHING



FINOTEC

Colour	Packaging	Consumption
White	25 KG	3.7 kg/m ² for 3 mm thickness

DESCRIPTION

White finishing (fino) with a cement base for interior walls, ceilings, and facades. Suitable for all types of cement-lime based substrates that do not have high flexibility characteristics. Unsuitable for direct application on gypsum-based substrates or surfaces previously painted.

FIELD OF APPLICATION

Used mainly on all types of cement-lime and lime-cement based substrates, such as traditional filler plasters and ready-mixed plasters. Applied in one or two coats for smoothing ceilings, interior, and exterior walls. Characterized by very good workability and optimal drying time.

SUBSTRATE PREPARATION

The substrate must be clean, free of dust, oils, or residues that could hinder bonding between layers. Cleaning of the substrate is done mechanically or manually. Substrates with high absorbency should be pre-wetted before applying the product.

APPLICATION

Mix 6.5–7 liters of water with a 25 kg bag of FINOTEC using an electric mixer in a clean container, until a homogeneous, lump-free mixture is obtained. Let the product rest for 10 minutes, then mix again before use. Apply the product with a trowel and level it to a thickness of 3 mm. After 10–15 minutes, rub the surface with a sponge float until the grain is exposed. Weather conditions affect the drying time of the product.



TECHNICAL DATA

Appearance: Powder	Paint Application: 20 days
Packaging: Paper bag 25 kg on pallets of 1350 kg	pH of mixture: 13
Colour: White	Granulometry: 0.7 mm
Consumption: 3.7 kg/m2 (3mm thickness)	Application Temperature: +5°C to +35°C
Storage: On wooden pallets	Compressive Strength: 2.5 N/mm ²
Storage Time: 12 months from the production date	Flexural strength: 1.1 N/mm ²
Bulk Density: 1.4-1.5gr/cm ³	Water Absorption: WO
Water mixture: 6.5-7 liters of water for 25 kg bag	Reaction to fire: Class A1
Application method: One or two hands	

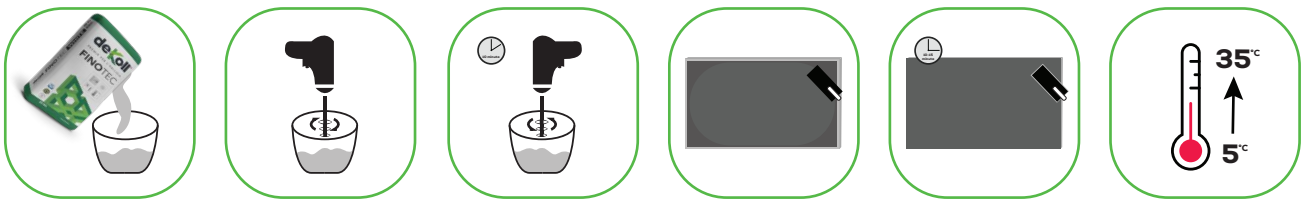

WARNING! The application of fine plaster is not recommended on highly flexible substrates such as external thermal insulation systems (ETICS) or other flexible products, on unstable surfaces, or on surfaces with large irregularities. Low or high temperatures may alter the working characteristics of the product (slowing down or speeding up the drying process). Do not use on:

- Wooden, metal, PVC, or other non-cement-based substrates.
- Environments with continuous moisture.
- Substrates characterized by unstable vibrations.
- In high or low temperatures, or in strong wind.