

FINISHING



DEKOFIN

Colour	Packaging	Consumption
White, Grey	25 KG	3.7 kg/m ² for 3 mm thickness

DESCRIPTION

Cement-based product for finishing on interior walls, ceilings, and facades. Suitable for all cement lime based substrates. Not suitable for direct application on gypsum-based substrates or previously painted surfaces. Characterized by very good workability and high coverage.

FIELD OF APPLICATION

On all types of cement-lime and lime-cement based substrates such as traditional plaster and pre-mixed plasters. Apply one or two coats for ceilings, interior and exterior walls.

SUBSTRATE PREPARATION

The substrate must be clean, free of dust, oils, or residues that could hinder the bonding between layers. Cleaning of the substrate should be done mechanically or manually. Substrates with high absorbency should be pre-wetted before applying the product.

APPLICATION

Mix 7–7.5 liters of water with DEKOFIN in a clean container using an electric mixer until a homogeneous, lump free mixture is achieved. Let the product rest for 10 minutes, then mix again before use. Apply the product with a trowel and level it at a thickness of 3 mm. After 10–15 minutes, rub the surface with a float to remove granules. Not suitable for application on gypsum surfaces. Atmospheric conditions affect the drying time of the product.



TECHNICAL DATA

Appearance: Powder	Application method: One or two hands
Packaging: Bag paper 25 kg on pallets 1350 kg	Paint Application: 20 days
Colour: White, Grey	pH of mixture: 13
Consumption: 3.7 kg/m2 (3mm thickness)	Granulometry: 0.7 mm
Storage: On wooden pallets	Application Temperature: +5°C to +35°C
Storage Time: 12 months from the production date	Compressive strength: 6.6N/mm²
Bulk Density: 1.4-1.5 gr/cm³	Water absorption: WO
Water mixture: 7-7.5 liters of water for 25 kg bag	Thermal conductivity: 0.53 λ 10,dry
Thickness: 1-2 mm/hand	Reaction to fire: A1 Class

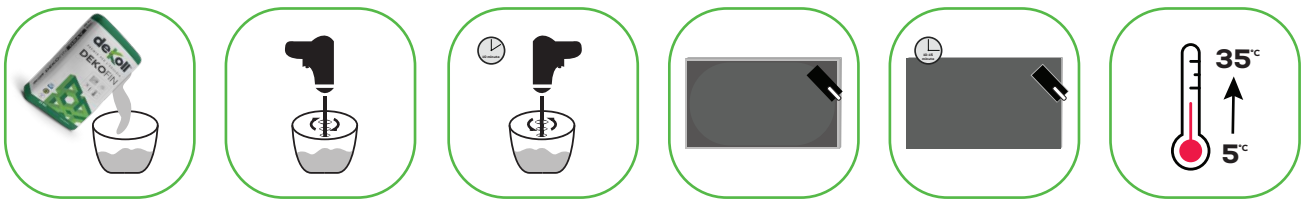

WARNING! The application of finishing (finos) is not recommended on supports with high flexibility such as the kapot system or other flexible products, on unstable surfaces, or on large unevenness. Both low and high temperatures can change the working characteristics of the product (slowing down or speeding up the drying process). Do not use on:

- Wooden, metal, PVC supports, or other non-cement-based surfaces.
- Environments with continuous humidity.
- Supports characterized by unstable vibrations.
- High or low temperatures, or strong winds.